

SprayPartner

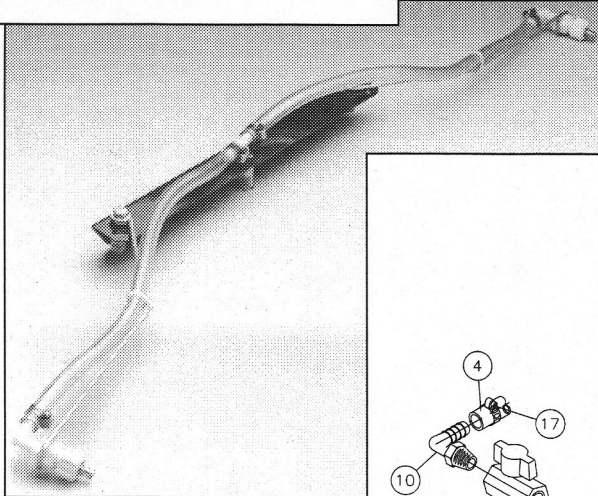

Spray Boom

Installation Instructions

1. Loosen hose clamp on hose at pump and remove hose.
2. Remove Elbow fitting from top of pump and attach new Nipple fitting (#9) that you received with the Spray Boom attachment.
3. Attach Tee fitting (#18) to Nipple fitting (#9) as shown.
4. Re-attach Elbow fitting on the right side of the Tee fitting (as shown.) You can re-assemble the hose that goes to the spray wand to this Elbow fitting.
5. Connect another Nipple (#9) fitting to the left side of the Tee fitting.
6. Connect Valve (#8) to Nipple fitting.
7. Connect Elbow fitting (#10) to Valve fitting (#8.)
8. Slide hose clamp (#17) over Hose (#4). Then push hose onto Elbow (#10) and tighten clamp (#4.)
9. Attach sprayer arm and support bracket assembly to rear of sprayer tank using Bolts (#15) and Lockwashers (#16) as shown. Make sure the sprayer arms are on the top.
10. Slide hose clamp (#17) over the open end of the hose you assembled in step 8. Slide hose clamp (#4) on the open end of the hose and push the open end of the hose onto the hose tee (#7) and tighten clamp (#4).

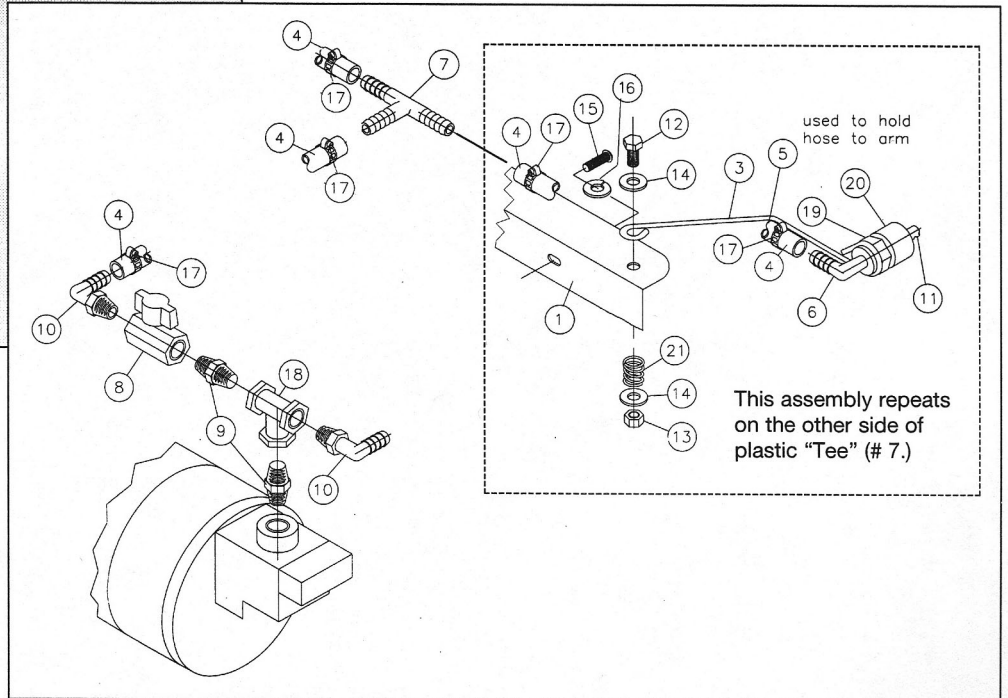

Parts List

Key	#Part No.	Description	Key	#Part No.	Description
1	M9578	Boom Bracket	12	113	5/16-18 x 1 1/2 Bolt
2	M9579	Boom Arm - Right (not shown)	13	114C	5/16-18 Nut
3	M9580	Boom Arm - Left	14	328	1/4 Flat Washer
4	M9581	3/8 x 7 Hose	15	M9591	1/4 - 20 x 1/2 PHMS
5	M9582	Wire Tie	16	396	1/4 Lockwasher
6	M9583	3/8 Elbow	17	M9463	#5 Hose Clamp
7	M9584	3/8 Hose Tee	18	M9594	1/2 Tee MPT
8	M9585	1/4 Valve 90	19	M9595	Nut B-12
9	M9586	1/4 Nipple M1400	20	M9596	Cap 8027
10	M9462	1/4 MPT x 3/8 HB Elbow	21	M9597	Spring
11	M9587	Nozzle Tip tk 1.5			

Operating Instructions

To operate the spray boom... turn the valve (#8) handle so it lines up with the valve body as shown above. Then pull out the switch button on the pump to activate .

To operate the Spray Wand... turn the valve (#8) so the valve handle is perpendicular to the valve. Then pull out the switch button on the pump and squeeze the handle on the Spray Wand to activate.

Specifications, descriptions, and illustrative material in this literature are as accurate as known at the time of publication, but are subject to change without notice

SprayPartner

Mantis

1028 Street Road
Southampton, PA. 18966
1-800-366-6268